

# CULTIVATING THE NATURAL TERROIR

WINERIES AND ESTATE HOMES

DESIGNED BY BAR ARCHITECTS & INTERIORS







## BAR ARCHITECTS & INTERIORS' *HISTORY of* WINERIES

[BAR Architects & Interiors](#) is an 85-person architectural, interior design and planning firm known for designing a diverse array of award-winning wineries, estate homes and hospitality projects throughout the United States and internationally.

We have designed over 30 wineries ranging from 2,500 to 500,000 cases that include wine production and storage facilities, visitor centers, tasting rooms, reception areas, art galleries, conference facilities and retail operations as well as the design of vineyards, caves and winery tour sequence. In all of our projects, we incorporate sustainable design and construction principles, material selections and system designs to utilize resources in the most responsible way.

COVER, LEFT PAGE + ABOVE: **LAW WINERY – PASO ROBLES, CA**

# CELEBRATING *the* ART OF ENTERTAINING

*Extensive hospitality experience expressing the synergy between wine and the arts. Designing homes that provide the perfect setting to enjoy family, good food and friends.*

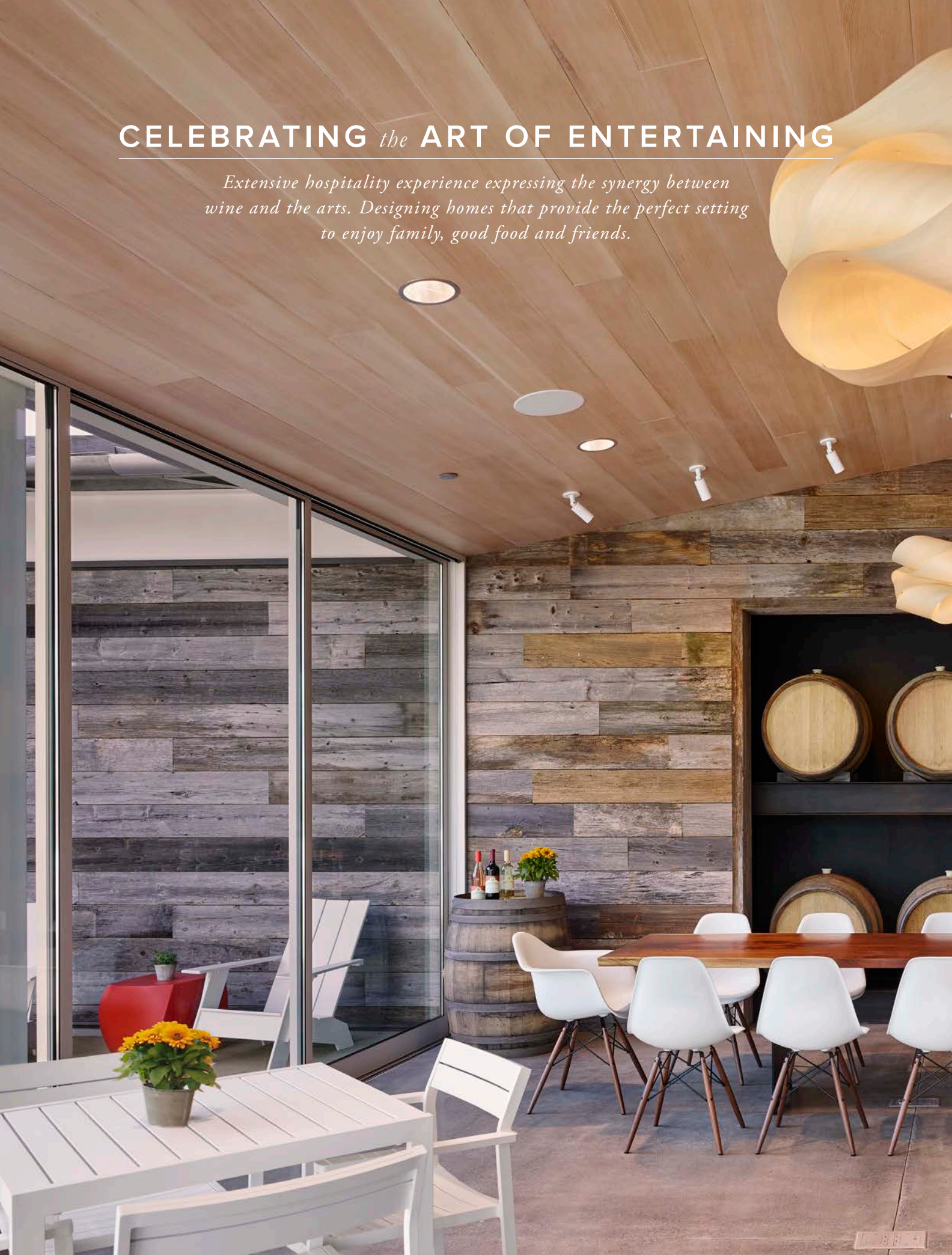





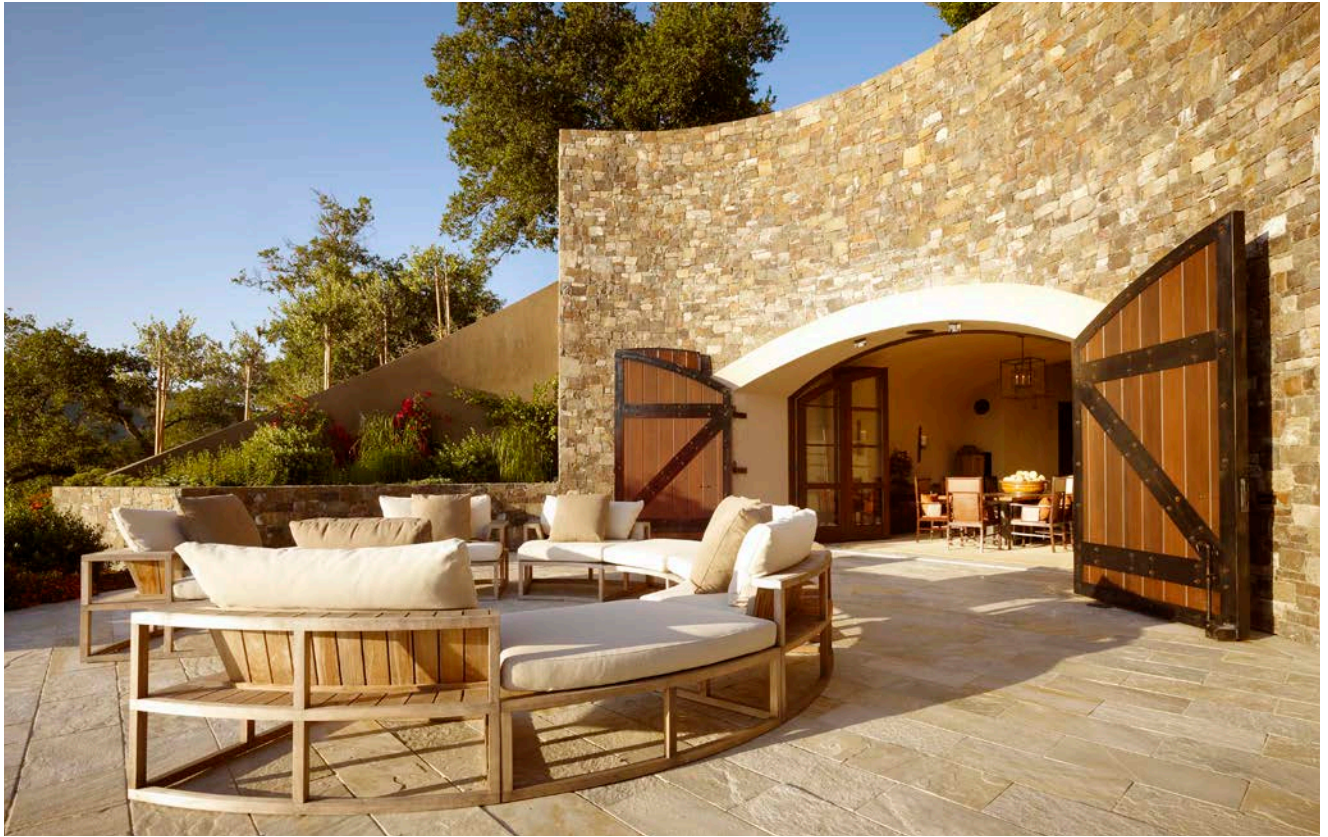

LEFT PAGE: TRINCHERO WINERY AND HOSPITALITY CENTER – ST. HELENA, CA TOP: SODA CANYON RESIDENCE WINE CELLAR – NAPA VALLEY, CA  
BOTTOM: LAW WINERY – PASO ROBLES, CA

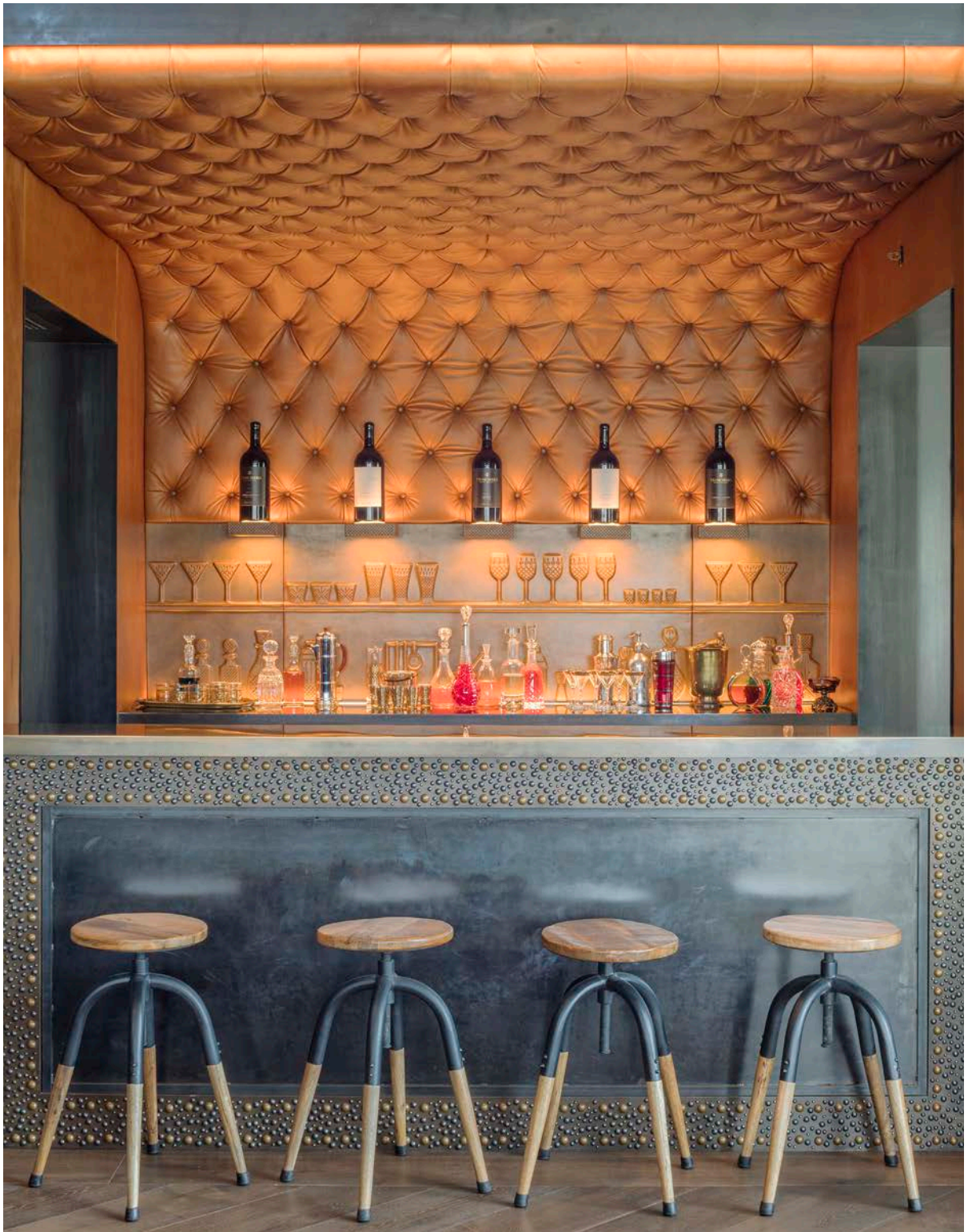

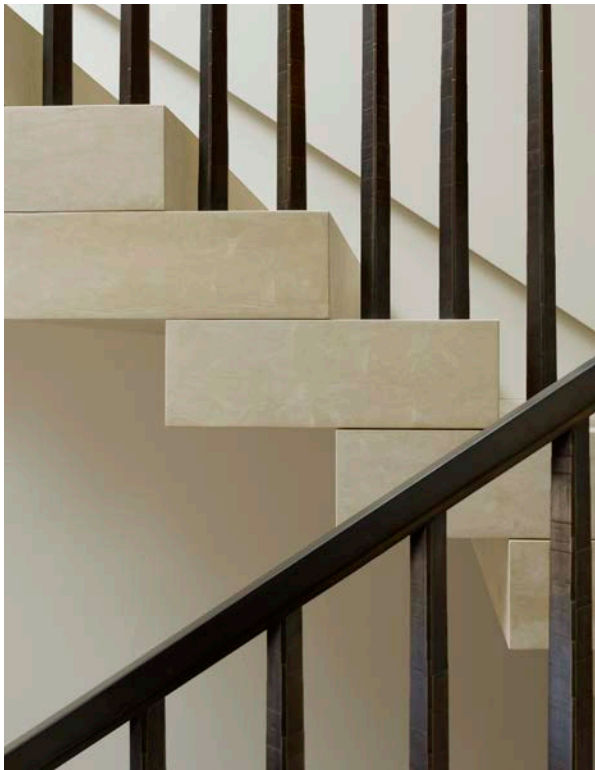

LEFT PAGE: TRINCHERO WINERY AND HOSPITALITY CENTER – ST. HELENA, CA TOP: SODA CANYON RESIDENCE – NAPA VALLEY, CA  
 BOTTOM LEFT: PACIFIC AVENUE RESIDENCE, SAN FRANCISCO, CA BOTTOM RIGHT: PEBBLE BEACH RESIDENCE – PEBBLE BEACH, CA









LEFT PAGE: HEALDSBURG RESIDENCE – HEALDSBURG, CA TOP: SODA CANYON RESIDENCE – NAPA VALLEY, CA  
BOTTOM: THE BOULDERS – NORTHSTAR LAKE TAHOE, CA

# SUSTAINABILITY *and the* THE NATURAL TERROIR

*Design which celebrates the uniqueness of place. Creating great indoor/outdoor environments.  
Embracing local materials and building traditions.*





LEFT PAGE + BOTTOM LEFT: LAW WINERY – PASO ROBLES, CA TOP: TASTING ROOM – WILLAMETTE VALLEY, OR  
 BOTTOM RIGHT: ROBERT YOUNG ESTATE WINERY – GEYSERVILLE, CA

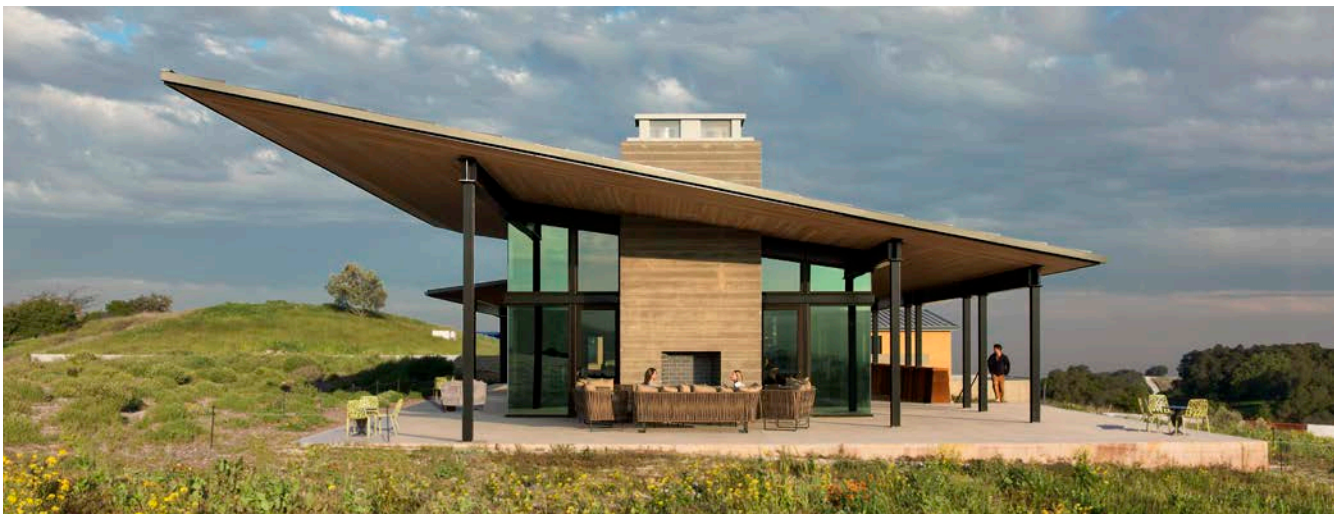
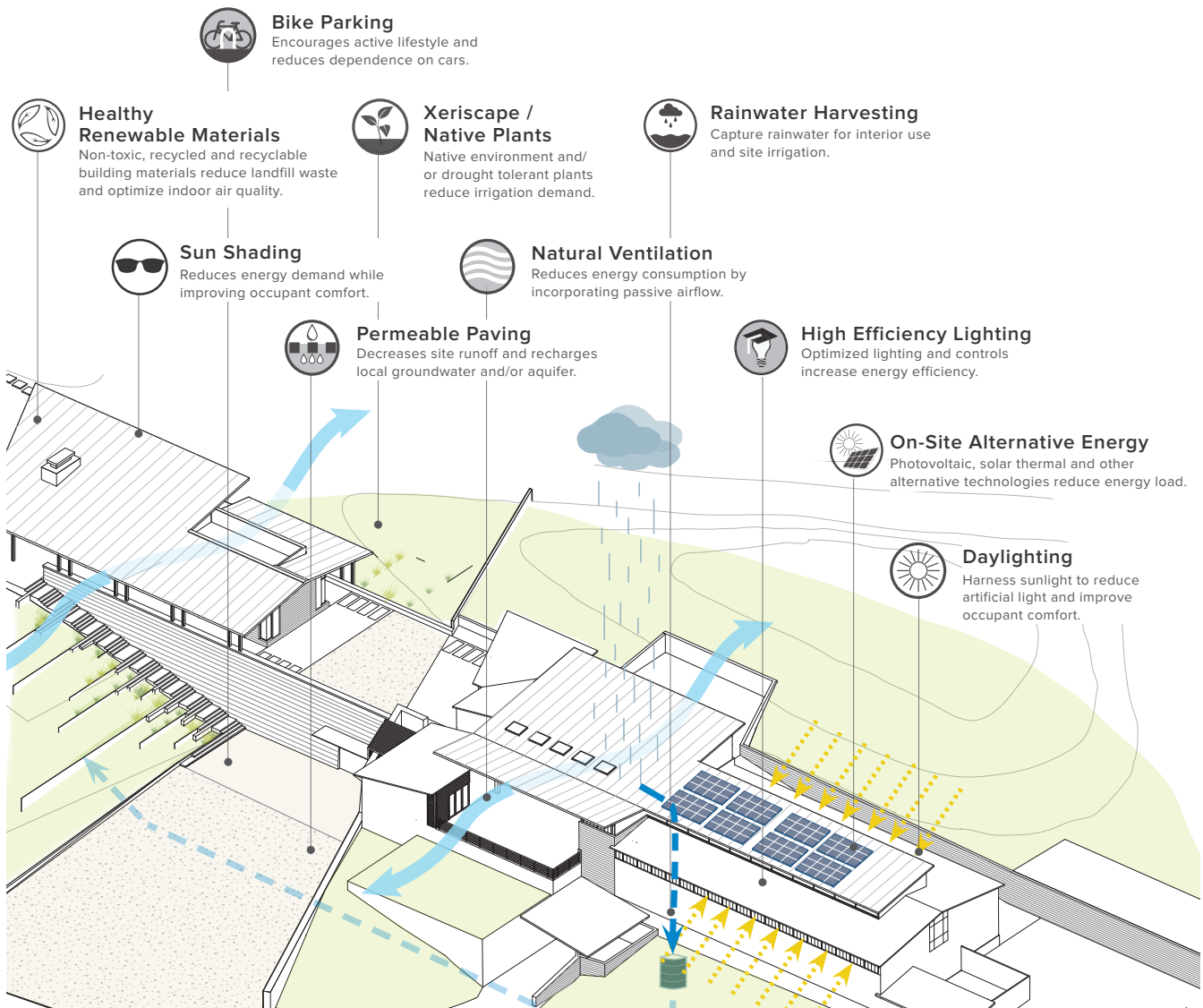

LAW WINERY – PASO ROBLES, CA

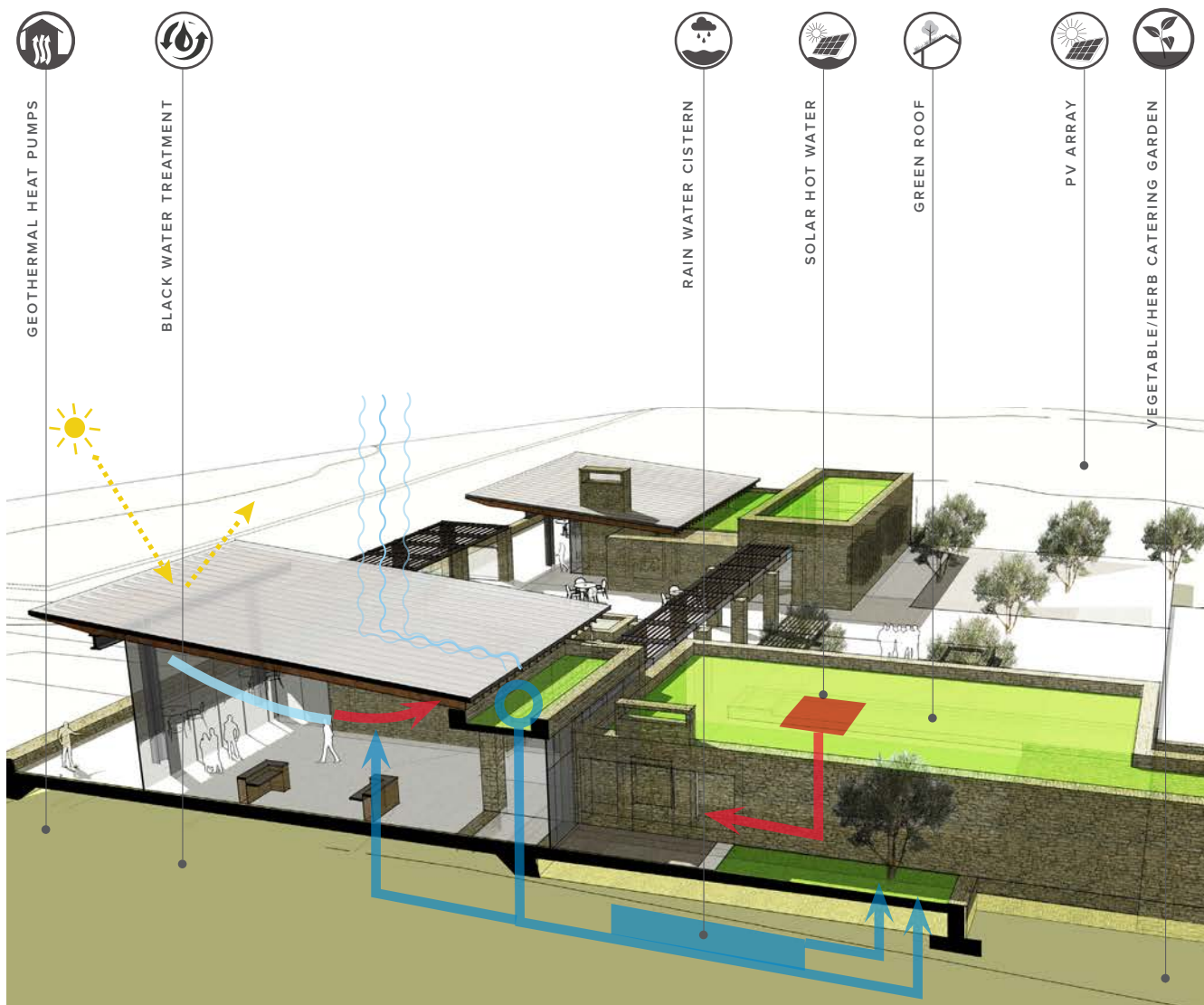

PARADISE VINEYARD – SONOMA COUNTY, CA

# BLENDING ART *and* SCIENCE

*Proven understanding of the winemaking process and the craft of building structures which are both beautiful and functional.*





LEFT PAGE: TRINCHERO WINERY AND HOSPITALITY CENTER – ST. HELENA, CA RIGHT PAGE: LAW WINERY – PASO ROBLES, CA

# BAR ARCHITECTS & INTERIORS'

## SELECT HISTORY *of* WINERIES

### 1975

**1976 - JORDAN WINERY, HEALDSBURG, CA** BAR'S FIRST WINERY OPENS

**1976 - "JUDGMENT OF PARIS"**

### 1985

**1985 - BAR BEGINS DESIGN ON ROBERT REDFORD'S SUNDANCE INSTITUTE RESORT**

**1990 - MUMM NAPA, RUTHERFORD, CA** FIRST WINERY DESIGNED BY BAR DEDICATED TO SPARKLING WINE

### 1995

**1995 - NAPA VALLEY VINTNERS SURPASSES 100 WINERIES**

**1996 - CARDINALE WINERY, OAKVILLE, CA** FIRST LARGE PRODUCTION WINERY (OVER 500,000 CASES) DESIGN BY BAR

**1996 - STONESTREET WINERY, HEALDSBURG, CA** OPENS

**1997 - BAR COMMENCES WORK ON SILVERADO AND ROBERT MONDAVI WINERIES**

**2000 - BAR WINS PCBC MERIT AWARD FOR ROBERT MONDAVI WINERY**

**2001 - ROBERT MONDAVI WINERY, OAKVILLE, CA** BAR'S 10TH WINERY OPENS

### 2005

**2006 - STARMONT WINERY, NAPA, CA** FIRST BAR-DESIGNED WINERY TO UTILIZE PV PANELS

**2007 - BAR COMMENCES WORK ON EUROPA VILLAGE AND PARADISE VINEYARD WINERIES**

**2008 - BAR CERTIFIED AS A SAN FRANCISCO BAY AREA GREEN BUSINESS**



**1980 - BAR WINS PCBC GOLD NUGGET MERIT AWARD FOR JORDAN WINERY**



**2004 - BAR'S VIANSIA WINERY FEATURED IN WINE COUNTRY: ARCHITECTURES AND INTERIORS**

**2009 - BAR COMMENCES WORK ON TRINCHERO WINERY**

## 2010

**2013** - LAW WINERY, PASO ROBLES, CA CRUSHES FIRST HARVEST

**2013** - PASO ROBLES NAMED WINE REGION OF THE YEAR BY *WINE ENTHUSIAST*

**2014** - BAR WINS *METAL ARCHITECTURE* DESIGN AWARD, 'BEST METAL BUILDING' FOR LAW WINERY

## 2015

**2015** - BAR SIGNS THE AIA 2030 COMMITMENT

**2015** - STARMONT WINERY TASTING ROOM OPENS

**2018** - BAR WINS AIA CA CENTRAL COAST AWARD OF CITATION FOR LAW WINERY

## 2019/20

**2019** - BOTH LAW AND TRINCHERO WINERIES FEATURED IN *THE NEW ARCHITECTURE OF WINE*

**2019** - LAW WINERY FEATURED IN *CAPTURE* MAGAZINE

**2019** - BEGIN MASTER PLAN AND TASTING ROOM ADDITION TO A WILLAMETTE VALLEY WINERY

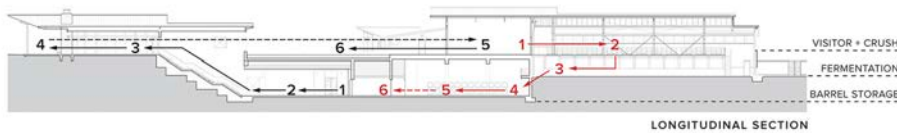

**AIA California Central Coast**

The American Institute of Architects  
California Central Coast Chapter  
Central Coast Area

**AWARD OF CITATION**

FOR

BAR ARCHITECTS

FOR EXCELLENCE IN THE DESIGN AND CONSTRUCTION OF THE

LAW WINERY

PANEL OF JUDGES  
Barry [Signature]  
Kathleen [Signature]  
Kathleen [Signature]  
October 18, 2018







## FEATURED PROJECTS

The Boulders — NORTHSTAR LAKE TAHOE, CA  
Total Area: 5,615 sf

Healdsburg Residence — HEALDSBURG, CA  
Total Area: 5,675 sf

Law Winery — PASO ROBLES, CA  
Production: 10,000 cases  
Total Area: 23,800 sf

Pacific Avenue Residence — SAN FRANCISCO, CA  
Total Area: 9,620 sf

Paradise Vineyard — SONOMA COUNTY, CA  
Production: 35,000 cases  
Total Area: 86,900 sf

Pebble Beach Residence — PEBBLE BEACH, CA  
Total Area: 14,000 sf

Robert Young Estate Winery — GEYSERVILLE, CA  
Production: 10,000 cases  
Total Area: 7,500 sf

Soda Canyon Residence — NAPA VALLEY, CA  
Total Area: 17,360 sf

Starmont Winery — NAPA, CA  
Production: 150,000 cases  
Total Area: 65,000 sf

Tasting Room — WILLAMETTE VALLEY, OR  
Production: 6,000 cases  
Existing Area: 9,175 sf  
New Area: 1,425 sf

Trinchero Winery and Hospitality Center —  
ST. HELENA, CA  
Production: 45,000 cases  
Total Area: 35,000 sf

## SELECTED CLIENTS

### UNDER DESIGN/BUILT SINCE 2010

Cass Winery, Paso Robles, CA  
Law Winery, Paso Robles, CA  
Mountain Peak Vineyards, Napa, CA  
Paradise Vineyards, Sonoma County, CA  
Tasting Room, Willamette Valley, OR  
Staglin Family Winery and Hospitality Center, Rutherford, CA  
Trinchero Family Estate, St. Helena, CA

### DESIGNED/BUILT BEFORE 2010

Branson Ridge Winery, Branson, MO  
Cardinale Winery, Oakville, CA  
Carlson Creek Winery, Wilcox, AZ  
Galante Vineyards, Carmel Valley, CA  
Gloria Ferrer Champagne Cellars, Sonoma Valley, CA  
Jordan Winery, Healdsburg, CA  
Kendall-Jackson Wine Center, Windsor, CA  
Kellogg Ranch, Knights Valley, CA  
Old Sugar Mill, Clarksburg, CA  
Mumm Napa Valley, Rutherford, CA  
Robert Mondavi To Kalon Winery Expansion, Oakville, CA  
Robert Young Estate Winery, Geyserville, CA  
Rombauer Vineyards Ramal Road Winery, Sonoma County, CA  
Silverado Vineyards, Napa, CA  
Starmont Winery, Napa, CA  
Stonestreet Winery, Healdsburg, CA  
Sutter Home, St. Helena, CA  
Viansa Winery, Sonoma, CA

## **BAR**architects &interiors

For more information about our work  
and how we can help realize your  
vision, please contact us:

77 Geary Street, Suite 200  
San Francisco, CA 94108  
415 293 5700

315 W. 9th Street, Suite 500  
Los Angeles, CA 90015  
213 349 0180

[bararch.com](http://bararch.com)

